

Stowell solutions for separating floors to help satisfy Robust Details part E

Robust Details E-FC-8

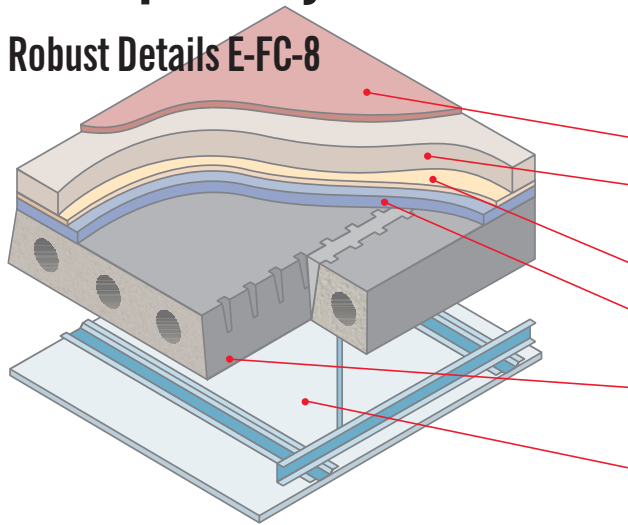

- precast concrete plank
 - screed laid on isolating layers
 - bonded resilient floor cover
- | | |
|-------------------|--|
| Floor covering | 4.5mm (min) bonded resilient covering |
| Screed | 65mm (min) sand/cement screed, or 40mm (min) proprietary screed, nominal 80kg/m ² (min) mass per unit area |
| Isolating layer 1 | 5mm formed polythene layer 30-36kg/m ³ |
| Isolating layer 2 | 25mm mineral wool batt 140kg/m ² (min), 25mm EPS (flooring grade SD) or extruded polystyrene insulation |
| Structural floor | 150mm (min) precast structural plank 300kg/m ² (min) mass per unit area (Stowell Hollowcore HC 300 – 155mm deep, 320kg/m ²) |
| Ceiling | CTO metal ceiling system providing 150mm (min) ceiling void with one layer of nominal 8kg/m ² gypsum-based board. |

Diagram shows CTO type ceiling treatment.

Robust Details E-FC-9

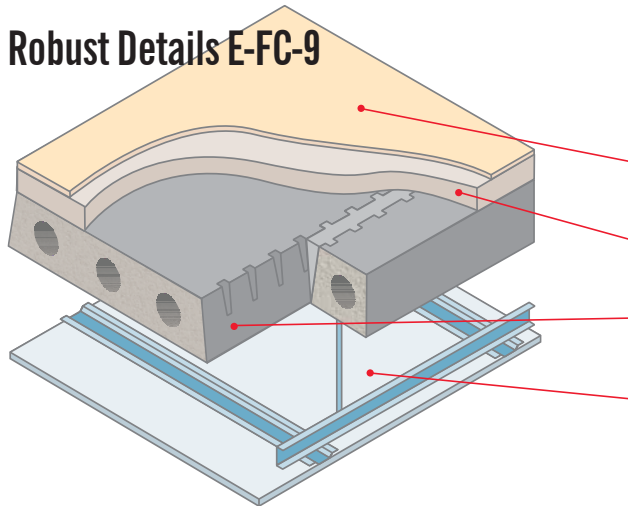

- precast concrete plank
 - screed
 - 3mm Thermal Economics IsoRubber top
- | | |
|------------------|--|
| Floor covering | 3mm Thermal Economics IsoRubber top (bonded with isobond adhesive) |
| Screed | 65mm (min) sand/cement screed, or 40mm (min) proprietary screed, nominal 80kg/m ² (min) mass per unit area |
| Structural floor | 150mm (min) precast structural plank 300kg/m ² (min) mass per unit area (Stowell Hollowcore HC 300 – 155mm deep, 320kg/m ²) |
| Ceiling | CTO metal ceiling system providing 150mm (min) ceiling void with one layer of nominal 8kg/m ² gypsum-based board. |

Diagram shows CTO type ceiling treatment.

Robust Details E-FC-11

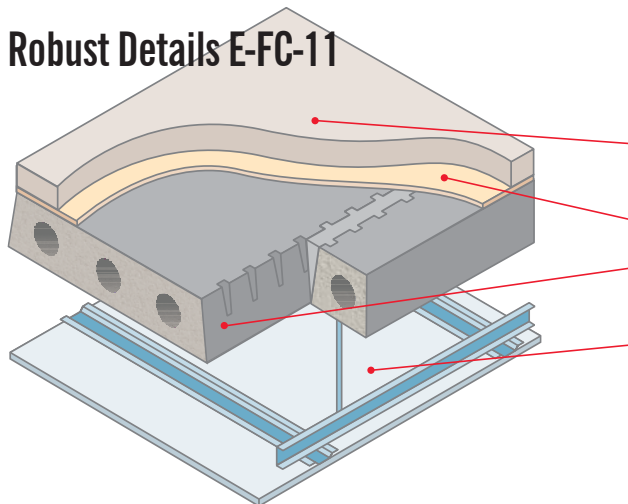

- precast concrete plank
 - screed laid on Tranquilt® resilient layer
- | | |
|------------------|--|
| Screed | 65mm (min) sand/cement screed, or 40mm (min) proprietary screed, nominal 80kg/m ² (min) mass per unit area |
| Resilient layer | 10mm Icopal-Monarfloor Tranquilt® |
| Structural floor | 150mm (min) precast structural plank 300kg/m ² (min) mass per unit area (Stowell hollowcore HC 300 – 155mm deep, 320kg/m ²) |
| Ceiling | CTO metal ceiling system providing 150mm (min) ceiling void with one layer of nominal 8kg/m ² gypsum-based board. |

Diagram shows CTO type ceiling treatment.

Robust Details are construction solutions which provide an alternative to pre-completion sound testing as a method of complying with Part E (resistance to the passage of sound) of the Building Regulations (England and Wales). Stowell concrete products enable builders to meet these regulations – provided the correct treatments are followed – when constructing new-build attached dwellings, flats and apartments. A synopsis of the construction treatments is provided above, with full details available from Robust Details Ltd (telephone 0870 240 8209 or www.robustdetails.com).

STOWELL
CONCRETE LIMITED

www.stowellconcrete.co.uk

Hollowcore layout and load tables

...for guidance only

To satisfy Robust Details E-FC-8, E-FC-9, and E-FC-11

A floor layout arrangement using Stowell HC300 planks

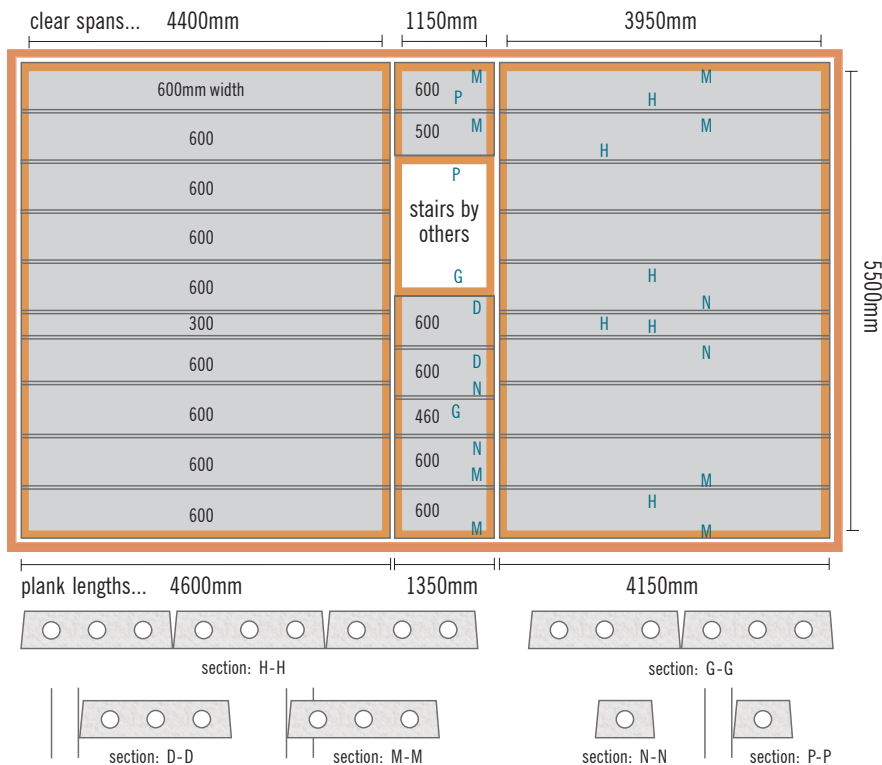

Stowell hollowcore flooring units are produced in the standard 155mm×600mm section to a selection of lengths ranging from 1.2 metres to a usefully long 7.0 metres – available in increasing increments of 50mm.

This table refers to simple, uniformly distributed loads and is only a guide...

HC 300 three core	Loadings in kN/m ²							
	1.5	2.0	2.5	3.0	3.5	4.0	5.0	7.5
Imposed live load	1.5	2.0	2.5	3.0	3.5	4.0	5.0	7.5
Partition allowance	0.5	0.5	1.0	1.0	1.0	–	–	–
Finishes & ceilings	0.3	0.3	0.3	0.3	0.3	0.15	0.15	0.15
	Max clear span in metres							
8mm reinforcement type A	3.80	3.75	3.55	3.50	3.45	3.50	3.35	3.10
10mm reinforcement type B	4.10	4.00	3.80	3.75	3.70	3.75	3.60	3.35
12mm reinforcement type C	4.25	4.15	4.00	3.90	3.85	3.90	3.80	3.50
16mm reinforcement type D	4.40	4.30	4.15	4.05	4.00	4.10	3.95	3.65



All products are available ex works.
Prices on application.
Telephone our sales office for further information and quotations.

STOWELL
CONCRETE LIMITED

Arnolds Way, Yatton, Bristol BS49 4QN
also at Holcombe, Cheddar & Weston-s-Mare
Tel: 01934 834000 Fax: 01934 835474
www.stowellconcrete.co.uk